

APPROXIMATELY 6300 FT OF NEW SIDEWALK CONNECTIVITY: TOM MILLER RD, PLAZA BLVD, SMITHFIELD BLVD

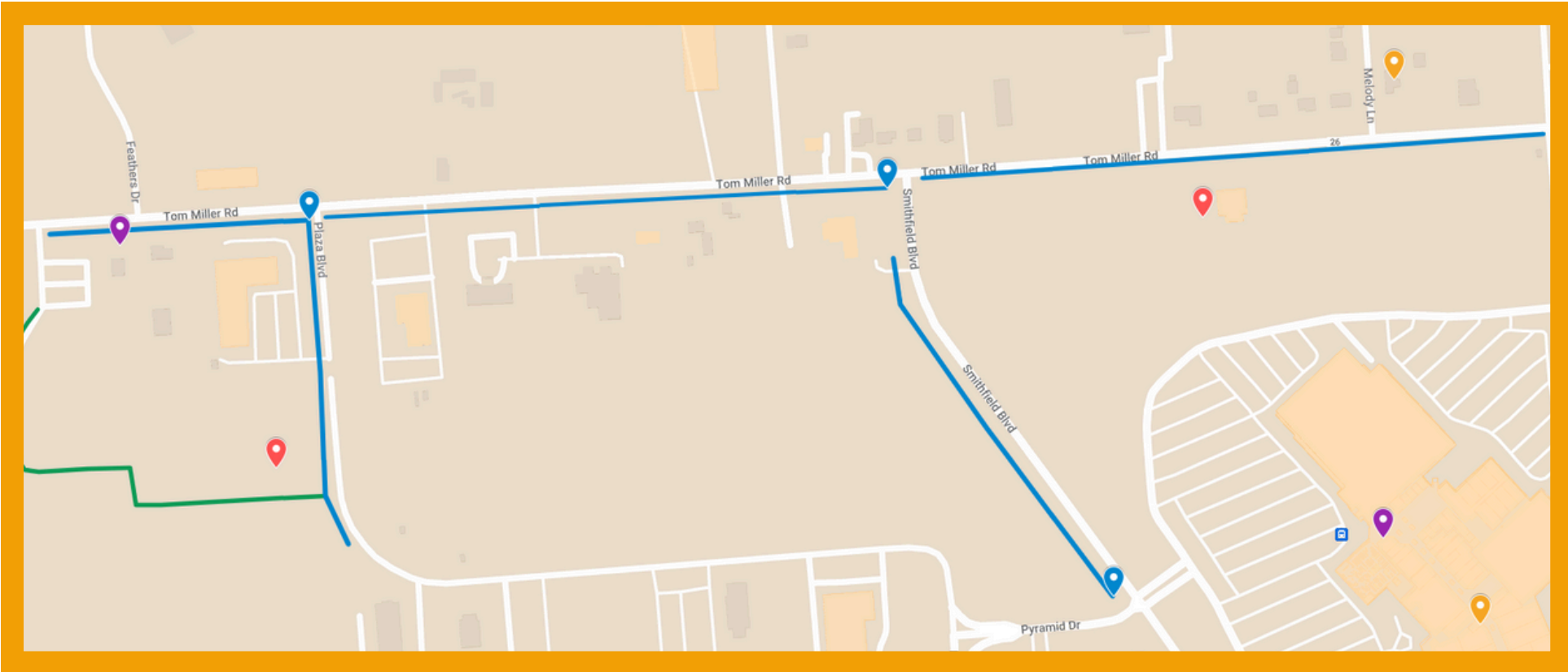

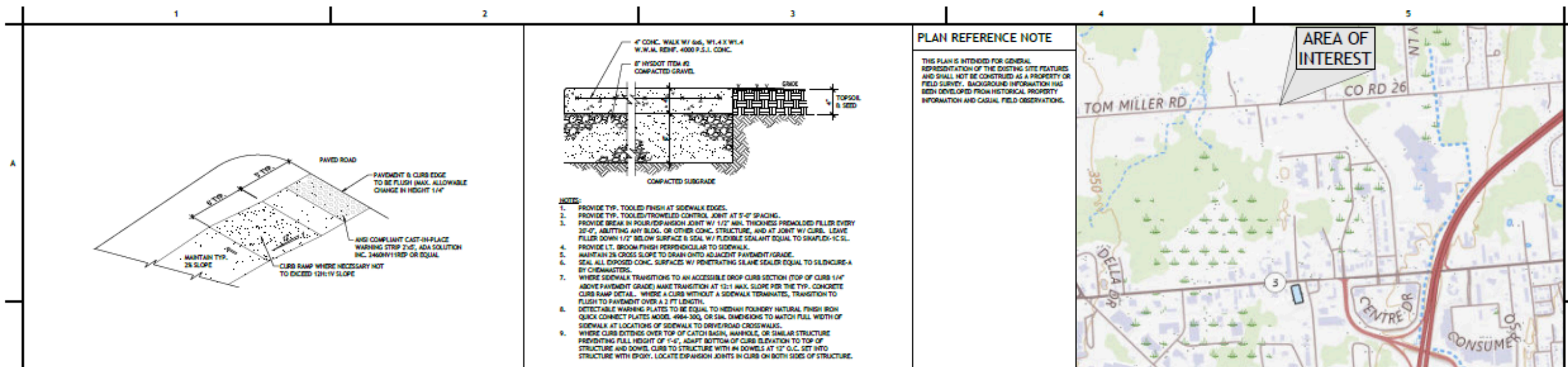

B1 TYP. SIDEWALK CURB RAMP DETAIL
C100 N.T.S.

B2 TYP. CONCRETE SIDEWALK DETAIL
C100 N.T.S.

PLAN REFERENCE NOTE
THIS PLAN IS INTENDED FOR GENERAL REPRESENTATION OF THE EXISTING SITE FEATURES AND SHALL NOT BE CONSTRUED AS A PROPERTY OR FIELD SURVEY. BACKGROUND INFORMATION HAS BEEN DEVELOPED FROM HISTORICAL PROPERTY INFORMATION AND CASUAL FIELD OBSERVATIONS.

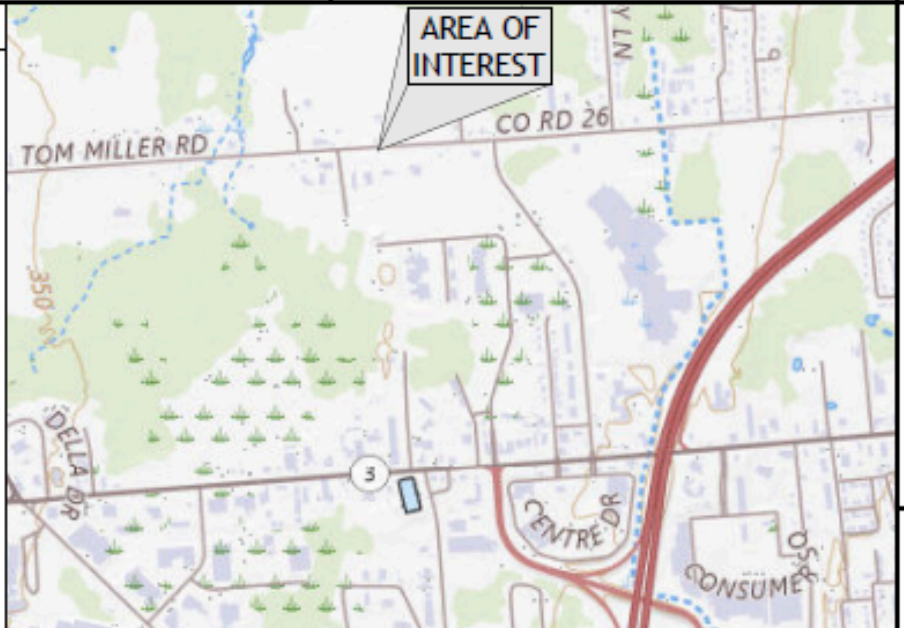

LOCATION PLAN
SCALE: 1" = 100'



D1 SITE PLAN
C100 SCALE: 1" = 200'



DISCLAIMER
COPYRIGHT © ARCHITECTURAL & ENGINEERING DESIGN, PLLC. ALL RIGHTS RESERVED. THIS PLAN IS A PRELIMINARY DESIGN AND SHALL NOT BE CONSTRUED AS A PROPERTY OR FIELD SURVEY. BACKGROUND INFORMATION HAS BEEN DEVELOPED FROM HISTORICAL PROPERTY INFORMATION AND CASUAL FIELD OBSERVATIONS. THE CLIENT HAS REVIEWED AND APPROVED THIS PLAN. THE CLIENT IS RESPONSIBLE FOR OBTAINING ALL NECESSARY PERMITS AND REGULATORY APPROVALS. THE CLIENT SHALL BE RESPONSIBLE FOR OBTAINING ALL NECESSARY PERMITS AND REGULATORY APPROVALS. THE CLIENT SHALL BE RESPONSIBLE FOR OBTAINING ALL NECESSARY PERMITS AND REGULATORY APPROVALS.

**TOWN OF PLATTSBURGH - DRI
PROJECT: PUBLIC SIDEWALK INFILL**
TOWN HALL RD., PLAZA BLVD. & SMITHFIELD BLVD., TOWN OF PLATTSBURGH, CATTARAUGUS COUNTY, NY

SCHEMATIC DESIGN PHASE SERVICES 60%



REVISIONS

#	BY	DATE

SITE SKETCH PLAN

PROJECT NO. 23025-002
DATE 09-23-24
DRAWN BY MEC
CHECKED BY JAA

C100